

# R500 SPI

Mechanical cylinder



## PRODUCT

The R500 SPI reversible key cylinder is a patented locking system which meets the highest safety standards required by both companies and privates. The R500 SPI is available in key different, key alike versions and suitable for Masterkey-systems.

## APPLICATION

The patented R500 SPI reversible key cylinder is recommended for security and armoured doors.

## VERSION

Available in compact and modular design as:

- single profile cylinder
- double profile cylinder
- pre-arranged for knob
- knob cylinder

Available in compact design as:

- scandinavian type
- rim cylinder
- round cylinder

## TECHNICAL PRODUCT FEATURES

- Cylinder body and plug made of brass in the standard version matt nickel-plated
- Suitable for installation in fire doors
- Encryption pins in stainless steel
- Counterpins in brass
- Springs in stainless steel
- Euro-profile cylinder (norm)
- Locking cam made of sintered steel
- Locking cam in min. 30° position (according to DIN)
- In each plug are 2 picking-resistant counterpins
- The drilling protection consists of hardened steel pin in the cylinder body and plug
- Patented SPI pin in key-profile, interacting with special pins in one chamber

## SINGLE PROFILE CYLINDER

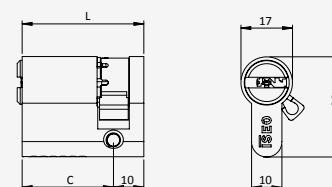

## EUROPEAN DOUBLE PROFILE CYLINDER

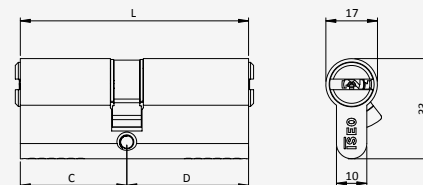

## EUROPEAN DOUBLE PROFILE CYLINDER. ROUND KNOB

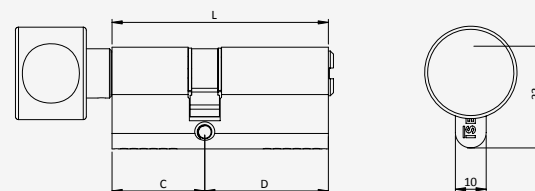

# R500 SPI

## Mechanical cylinder

### FEATURES

R500 SPI has 6 encryption pins in the inferior line, up to 4 pins in the lateral line and up to 5 pins in the superior line from a length of 30-30 made of wear-resistant special brass, per locking side.

A drilling protection as well as anti-pick protection is integrated in the profile cylinder.

The surface of the cylinder body is matt nickel-plated or brass as standard.

The keys are made of nickel silver. The key is available with a co-printed head in black/red (20 mm key neck) or with key-caps in 5 different colours (18 mm key neck)

Optionally selectable features:

- emergency and danger function
- free cam
- construction key

### STANDARDS

Compact and modular version:

DIN EN 1303: 2015-08

1|6|0|B|0|C|6|D

### EUROPEAN DOUBLE PROFILE CYLINDER. FOR ARMoured DOORS

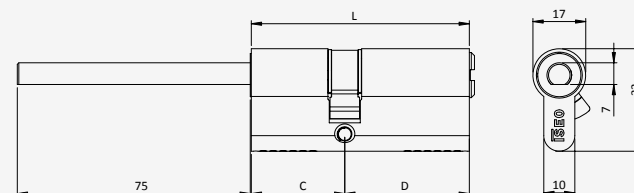

### EUROPEAN DOUBLE PROFILE CYLINDER. PREARRANGED FOR KNOB

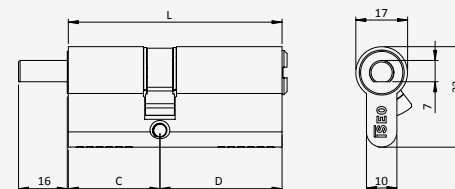

### OVAL SCANDINAVIAN CYLINDER

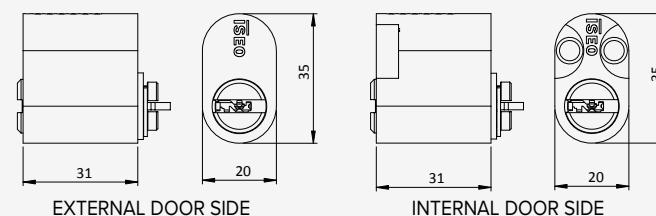

### EXTERNAL RIM CYLINDER

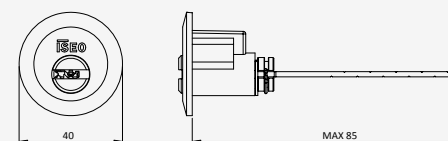

### FIXED EXTERNAL CYLINDER

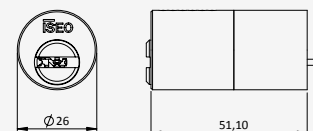

### INTERNAL CYLINDER

